

Office for Credit Suisse

Pune, Maharashtra

CLIENT : Credit Suisse Group (MFSC)
SCOPE : Interior Design
PROGRAM : Corporate Office
BUILT-UP AREA : 3,25,000 Sq.Ft.
STATUS : Completed

COLLABORATION : HASSELL Studio

The Credit Suisse workspace in EON Pune, in many ways, is a reflection of company's commitment to "Smart" working program, driven with a goal to attract the most talented professionals.

The new Credit Suisse workspace was designed with a scale of a small city block with series of neighbourhoods – each with desks, meeting rooms, printers, lockers and quiet areas. Each neighbourhood had a distinct personality, suited to the activities conducted within. This scale was integral to the design.

The client's brief was to bring in the local flavour of Pune and India as such on a broader theme. Inspirations were drawn from traditional Indian motifs and colours.





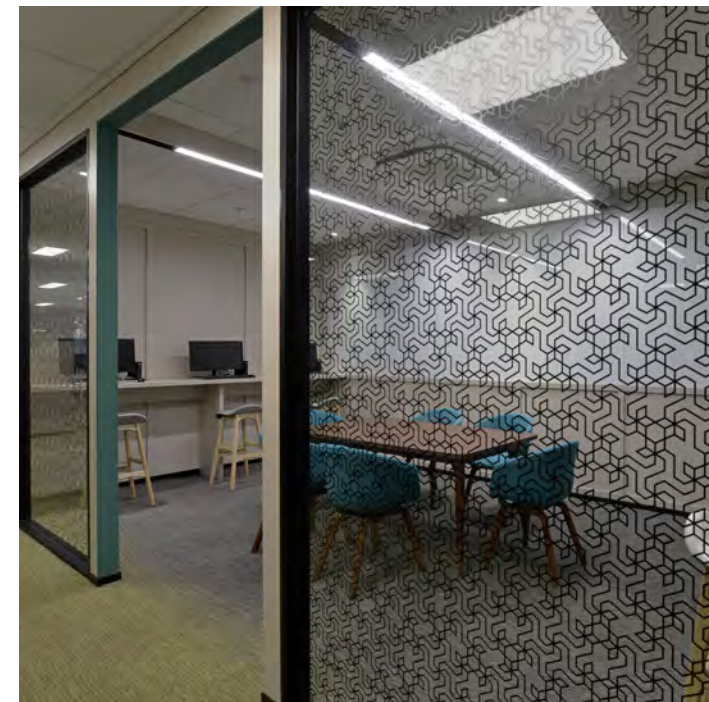
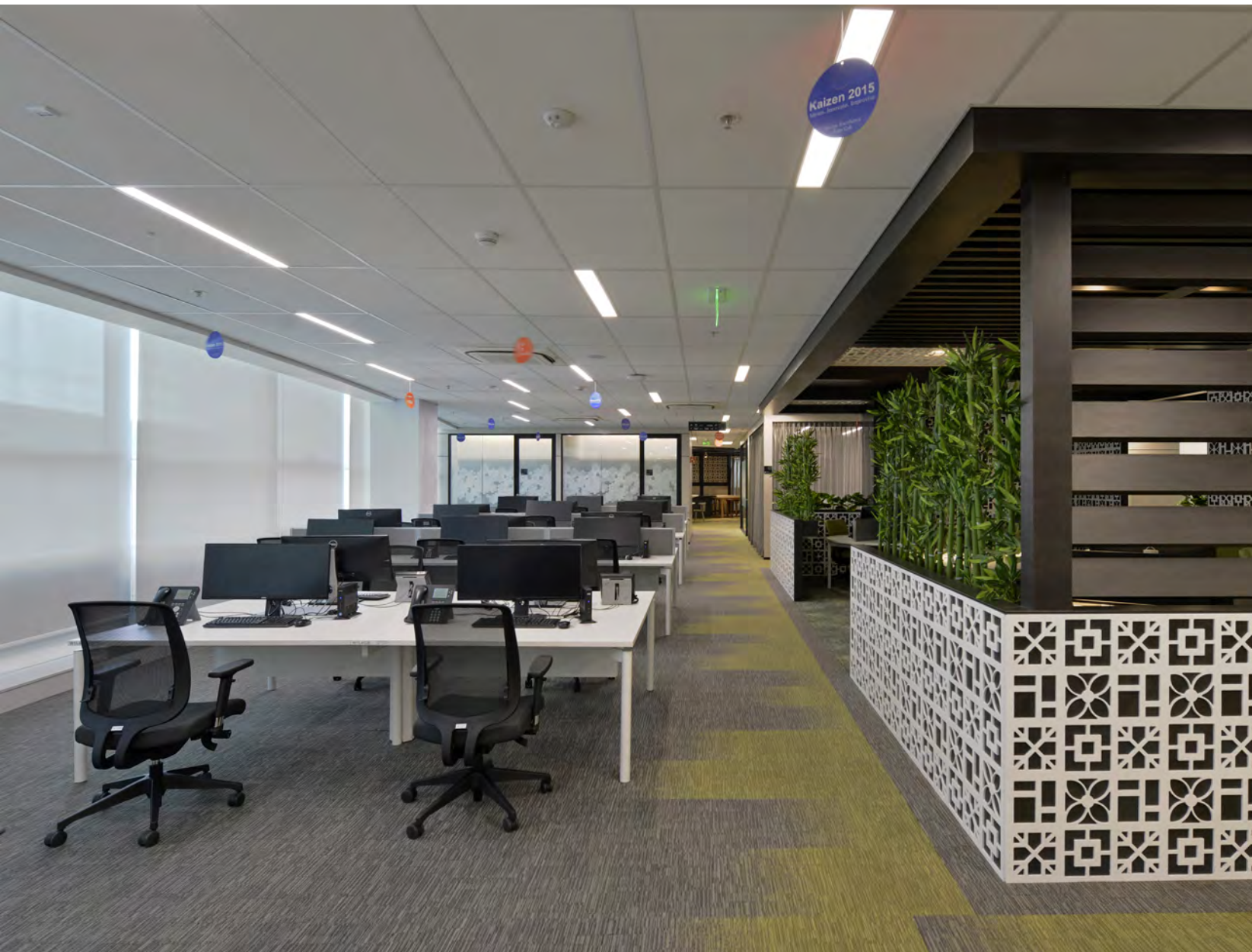

Each wing was assigned a different colour based on the “Navaratna”- or the nine gems. The colours ranged from purple to yellow to emerald green to blue signifying Sapphire. Every floor thus has a distinguished look and feel. Moreover, the different colours also add to the way finding scheme.

Physical program was all about movement of staff and ease of use, and did not seek to impose any rigid or hierarchical divisions. Entire office interiors had a feel of egalitarian design, where all spaces were treated equally and far removed from the typical corporate hierarchy.

Over all the design of the space breaks away from the typical regimental format and brings in a lot of freshness which has led to employee satisfaction and improved their overall performance.

